



3310-C Gilmore Industrial Boulevard
Louisville, Kentucky 40213

Phone (502) 964-8737
Facsimile (502) 964-1123

Facility Asbestos Inspection

Facility: 921 East 11th Street **Inspection Date:** 6-28-10
Location: New Albany, Indiana **Inspector:** Pete Welsh

Micro-Analytics, Inc. conducted a facility asbestos inspection at the facility identified above on the date indicated. The asbestos inspection was performed in accordance with the EPA recommended protocol for a facility asbestos inspection.

During the site inspection, suspect asbestos-containing materials were grouped into homogeneous areas (HA's), with any given homogeneous area being a material exhibiting the same color, texture, and physical appearance. Each suspect homogeneous area was then sampled in accordance with EPA protocol, and each sample collected was given a unique identification number.

Collected samples were then analyzed by an AIHA accredited laboratory using Polarized Light Microscopy (PLM) and the dispersion staining technique, which is the EPA-approved method for the analysis of bulk materials for the presence of asbestos.

This report summarizes the findings of the facility inspection. The report includes:

- An Asbestos Materials Summary Form, which details all of the asbestos-containing materials that were discovered during the inspection.
 - A Homogeneous Area Summary Form, which details all HA's that were identified during the inspection and includes both asbestos-containing materials and non-asbestos materials.
 - A Facility Drawing which shows locations of the samples collected and identifies the areas where asbestos materials are present in the facility.
 - A Bulk Analysis Report, which shows the analytical results from the laboratory for the PLM analysis.
-

Facility Asbestos Inspection – Summary of Asbestos-Containing Materials

Facility: 921 East 11th Street – Single Family Dwelling

Date of Inspection: 06-28-10

Location New Albany, Indiana

Inspector: Pete Welsh

| HA No. | Material Type | Description | Locations of Material | Material Quantity | Condition of ACM | Asbestos Type & Percent |
|--------|---------------|----------------------|-----------------------------|-------------------|------------------|-------------------------|
| 01 | Misc | 9" floor tile/mastic | Kitchen | 120 SF | Deteriorated | 1-3% Chrysotile |
| 06 | Misc. | Chimney mastic | Roof (under metal flashing) | 12 SF | Good | Assumed |

Facility Asbestos Inspection – Summary of Homogeneous Areas

Facility: 921 East 11th Street Single Family Dwelling

Date of Inspection: 06-28-10

Location New Albany, Indiana

Inspector: Pete Welsh

| HA No. | Description | Locations of Material | Material Type | Material Quantity | Sample Numbers | Is Asbestos Present? |
|--------|----------------------|-----------------------------|---------------|-------------------|----------------|----------------------|
| 01 | 9" floor tile/mastic | Kitchen | Misc. | 120 SF | 1.1 – 1.3 | Yes |
| 02 | Drywall/mud | Stairs | Surfacing | N/A | 2.1 – 2.3 | No |
| 03 | Plaster | Column | Surfacing | N/A | 3.1 – 3.3 | No |
| 04 | Window caulk/glazing | Exterior | Misc. | N/A | 4.1 – 4.3 | No |
| 05 | Asphalt shingle | Garage | Misc. | N/A | 5.1 – 5.3 | No |
| 06 | Chimney mastic | Roof (under metal flashing) | Misc. | 12 SF | N/A | Yes - Assumed |

Notes:

Floor Plan Drawings

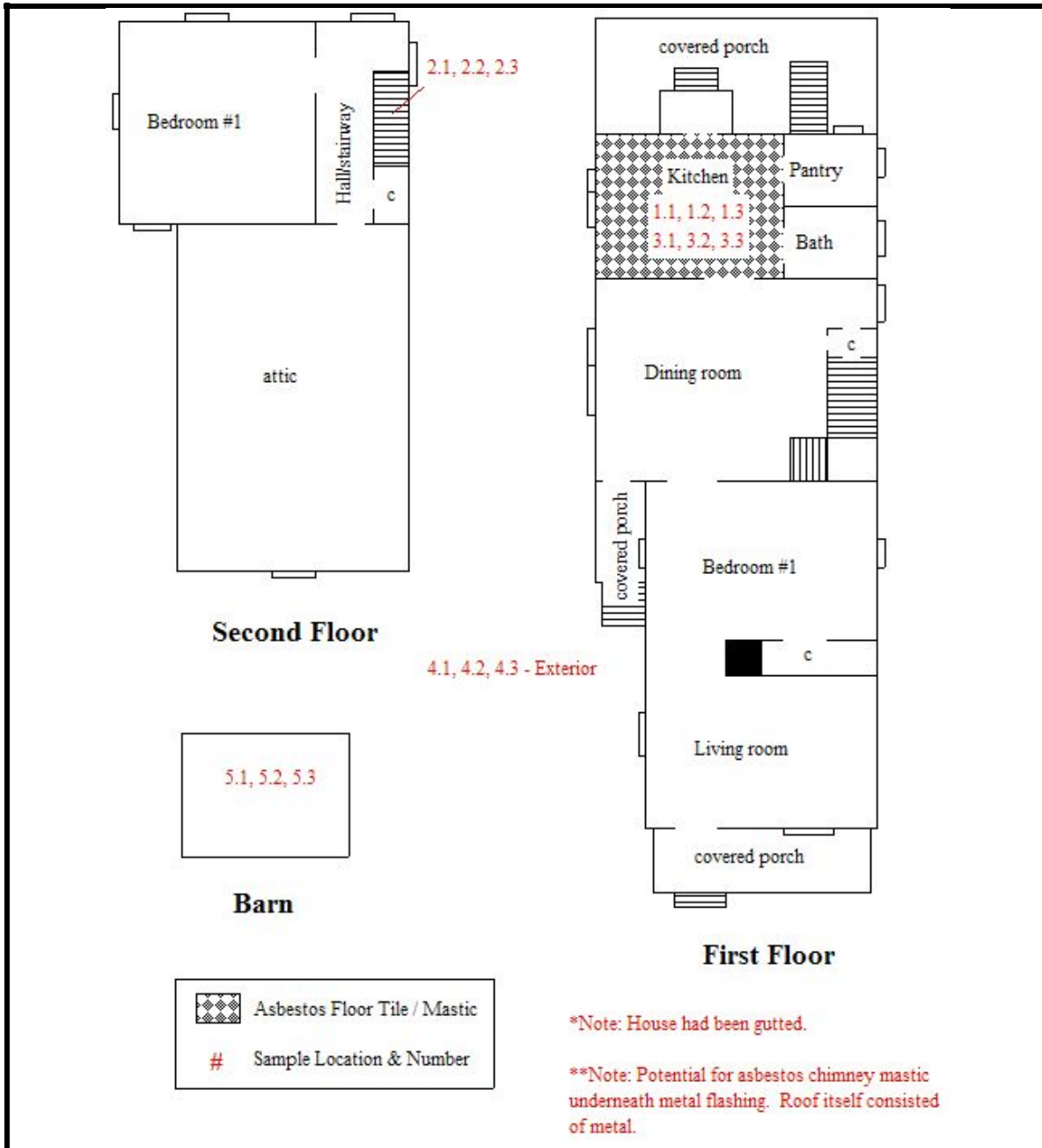

| | | | |
|--|--|-----------------|--------------|
| <p>Micro-Analytcs, Inc. 3310-C Gilmore Industrial Blvd. Louisville, KY 40213 (502)964-8737</p> | 921 East 11th Street, New Albany, IN | | |
| | Project # | Drawn by | Scale |
| | 62833 | N. Leow | NTS |
| | | Date | July 1, 2010 |

MRS Analytical Laboratory, Inc.

Bulk Asbestos Report

Project Number: 62833 Date Received: 06/28/2010
Client: New Directions Housing Corporation Date Reported: 06/29/2010
Facility: 921 E. 11th Street, New Albany Analysis Date: 06/29/2010
Sample Type: Bulk Material Analyst: J. Holley
Date Sampled: 06/28/2010 Sampled By: P. Welsh/N. Leow

TEST DESCRIPTION: Analysis of Bulk Material for Asbestos.

ANALYTICAL METHOD: Polarized Light Microscopy with Dispersion Staining as Defined in 40 CFR, Part 763, Subpart F, Appendix A.

| <i>Micro-Analytics Sample Number</i> | <i>Client Sample Number and Laboratory Gross Description</i> | <i>Type and Percent Asbestos</i> |
|--------------------------------------|--|----------------------------------|
| 1.1 | 9" Floor tile – blue | Chrysotile 1-3 |
| | 9" Floor tile – tan | Chrysotile 1-3 |
| | Black mastic | Chrysotile 2-3 |
| 1.2 | 9" Floor tile – blue | Chrysotile 1-3 |
| | 9" Floor tile – tan | Chrysotile 1-3 |
| | Black mastic | Chrysotile 2-3 |
| 1.3 | 9" Floor tile – blue | Chrysotile 1-3 |
| | 9" Floor tile – tan | Chrysotile 1-3 |
| | Black mastic | Chrysotile 2-3 |
| 2.1 | Drywall / Mud Compound | NAD |
| 2.2 | Drywall / Mud Compound | NAD |
| 2.3 | Drywall / Mud Compound | NAD |
| 3.1 | Plaster – top | NAD |
| | Plaster – bottom | NAD |
| 3.2 | Plaster – top | NAD |
| | Plaster – bottom | NAD |
| 3.3 | Plaster – top | NAD |
| | Plaster – bottom | NAD |
| 4.1 | Window Caulk/Glazing | NAD |
| 4.2 | Window Caulk/Glazing | NAD |

Reporting Limit 1% Asbestos

NAD: No Asbestos Detected

MRS Analytical Laboratory, Inc., is accredited and certified Proficient by the American Industrial Hygiene Association – Accreditation Number: AIHA-102459

Reviewed by Authorized Signatory



